

ATLANTIC CROSSINGS

# CORAL SPRINGS, FL

750-938 NORTH UNIVERSITY DRIVE

±1,187 SF AVAILABLE FOR LEASE; GLA: 173,680 SF

JOIN



sam's club



LOCATED AT THE INTERSECTION OF UNIVERSITY DRIVE AND ATLANTIC BLVD



get in touch.

**ALYONA TSUTSKOVA**

office 786.671.4020  
direct 786.470.4906  
alyona@metrocommercial.com

**CARLOS GUZMAN**

office 786.671.4020  
direct 786.671.4028  
cguzman@metrocommercial.com

# SURROUNDED BY DENSELY POPULATED AREA WITH STRONG HOUSEHOLD INCOMES

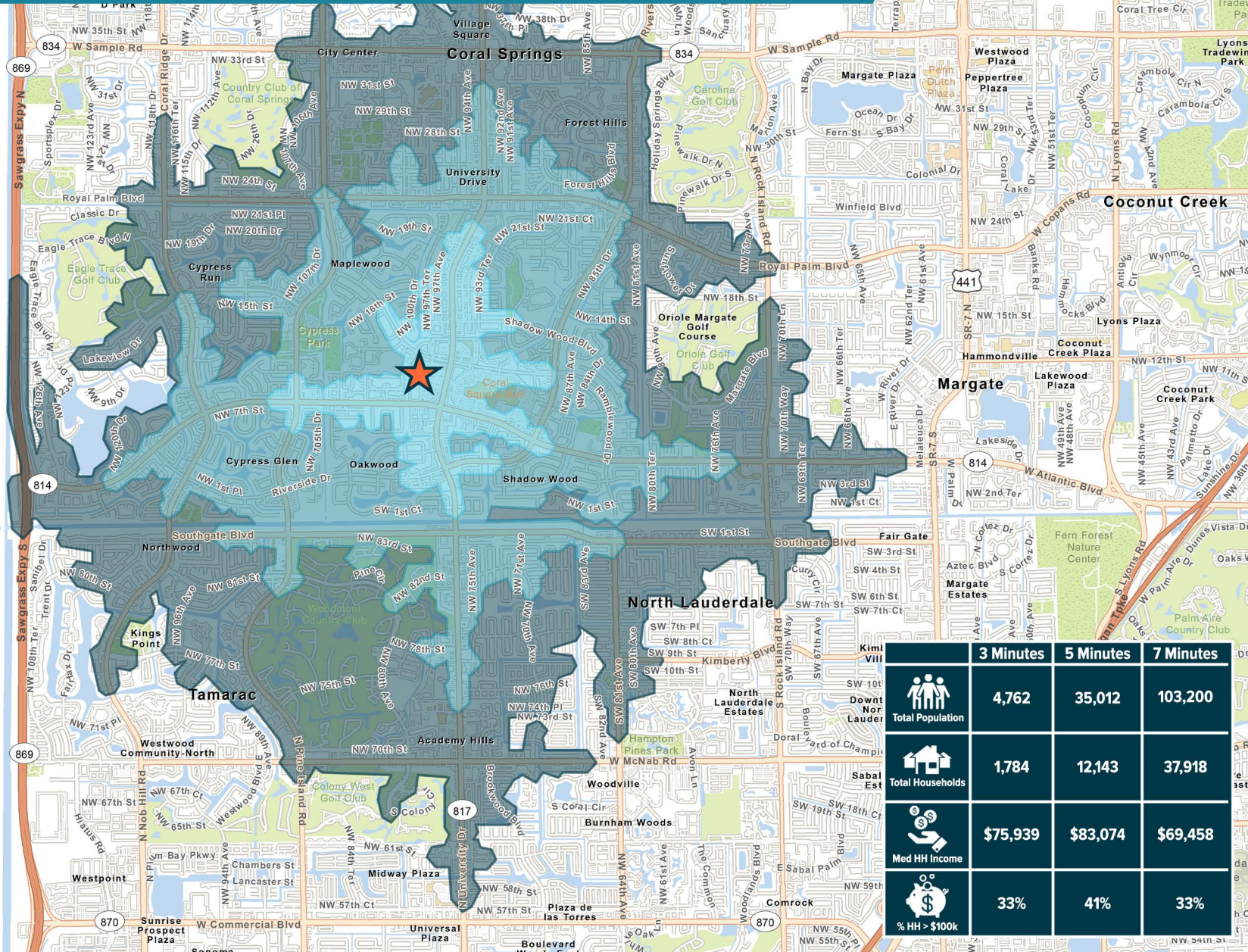

	3 Minutes	5 Minutes	7 Minutes
Total Population	4,762	35,012	103,200
Total Households	1,784	12,143	37,918
Med HH Income	\$75,939	\$83,074	\$69,458
% HH > \$100k	33%	41%	33%

The information and images contained herein are from sources deemed reliable. However, Metro Commercial Real Estate, Inc. makes no representation whatsoever as to their accuracy or authenticity. Images shown may be modified for illustrative purposes. Images may be out-of-date and not current. 10.25.24

ATLANTIC CROSSINGS  
**CORAL SPRINGS, FL**  
 750-938 NORTH UNIVERSITY DRIVE



MetroCommercial.com

# MERCHANT MAP

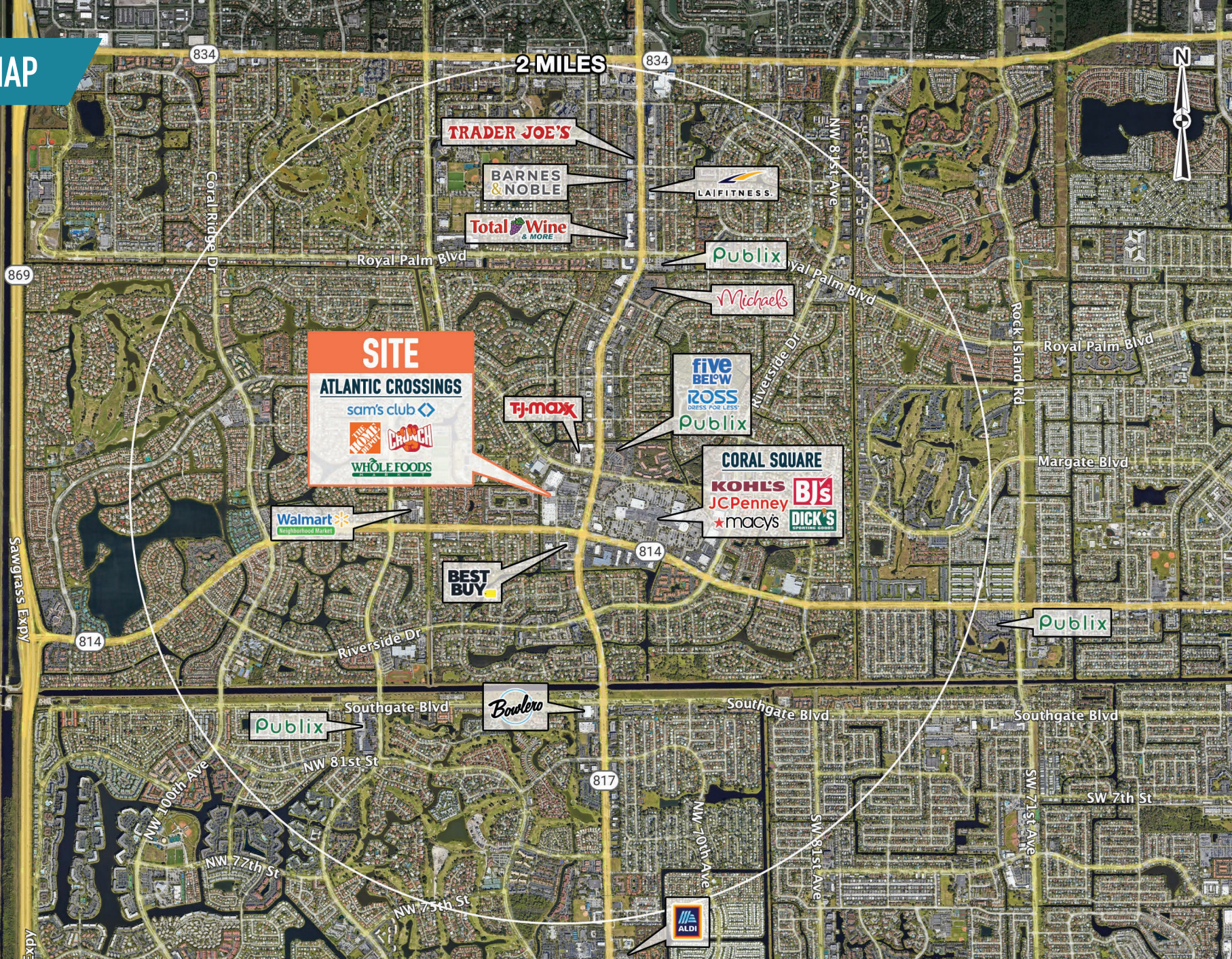

The information and images contained herein are from sources deemed reliable. However, Metro Commercial Real Estate, Inc. makes no representation whatsoever as to their accuracy or authenticity. Images shown may be modified for illustrative purposes. Images may be out-of-date and not current. 10.25.24

ATLANTIC CROSSINGS  
**CORAL SPRINGS, FL**  
750-938 NORTH UNIVERSITY DRIVE



MetroCommercial.com

LOCATED ACROSS THE STREET FROM CORAL SQUARE MALL



The information and images contained herein are from sources deemed reliable. However, Metro Commercial Real Estate, Inc. makes no representation whatsoever as to their accuracy or authenticity. Images shown may be modified for illustrative purposes. Images may be out-of-date and not current. 10.25.24

ATLANTIC CROSSINGS  
CORAL SPRINGS, FL  
750-938 NORTH UNIVERSITY DRIVE



MetroCommercial.com

# SITE PLAN

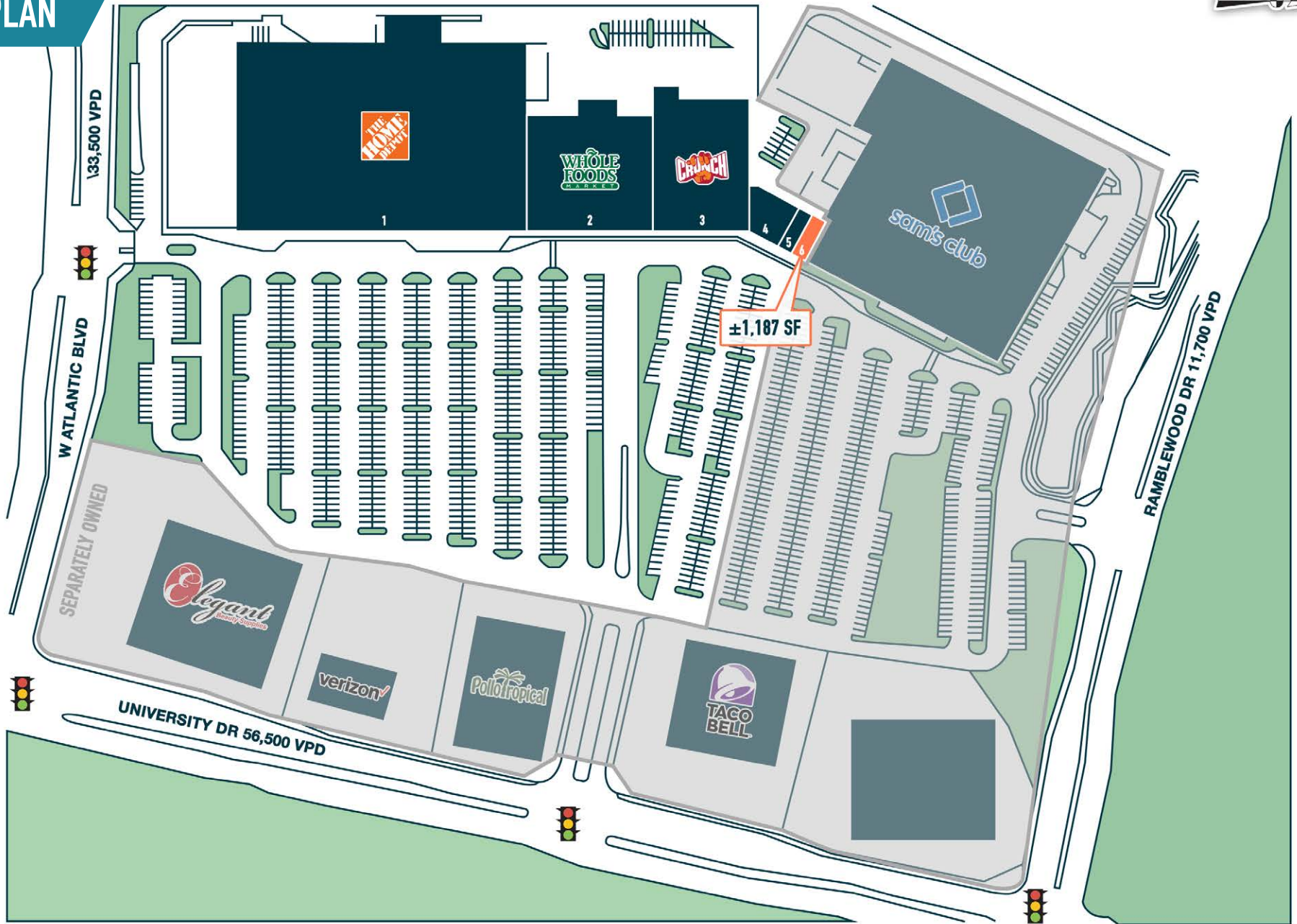

The information and images contained herein are from sources deemed reliable. However, Metro Commercial Real Estate, Inc. makes no representation whatsoever as to their accuracy or authenticity. Images shown may be modified for illustrative purposes. Images may be out-of-date and not current. 10.25.24

ATLANTIC CROSSINGS  
**CORAL SPRINGS, FL**  
750-938 NORTH UNIVERSITY DRIVE



MetroCommercial.com

# FLOOR PLAN - SPACE 6

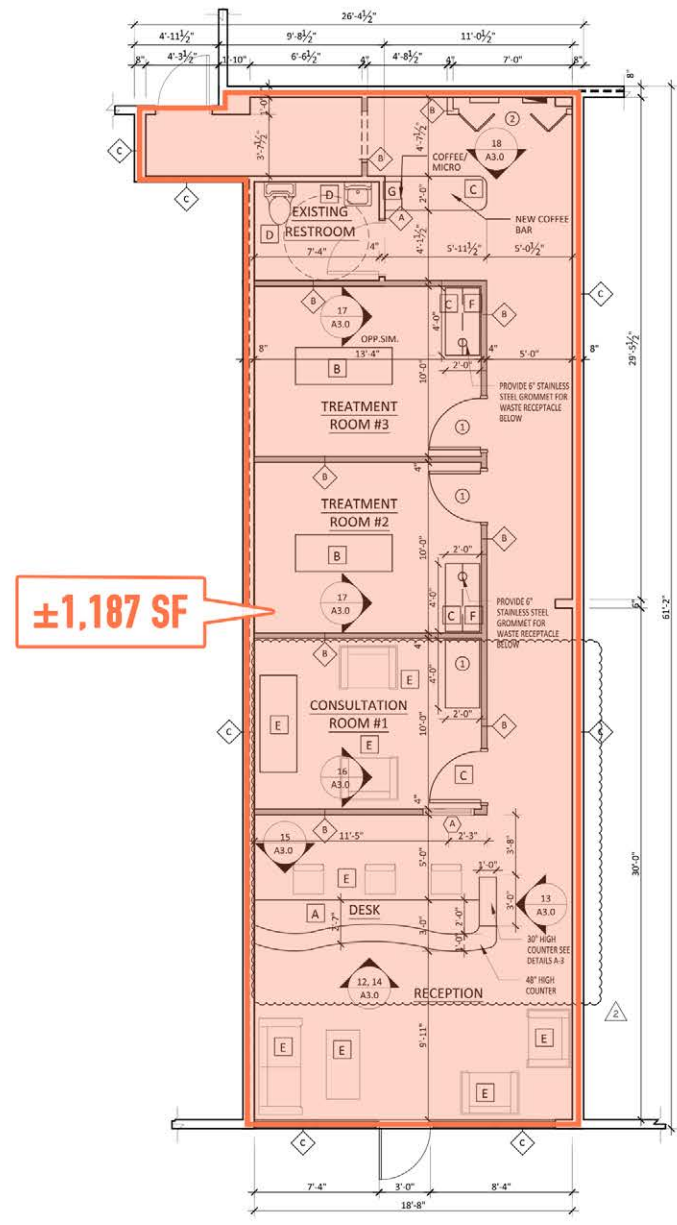

The information and images contained herein are from sources deemed reliable. However, Metro Commercial Real Estate, Inc. makes no representation whatsoever as to their accuracy or authenticity. Images shown may be modified for illustrative purposes. Images may be out-of-date and not current. 10.25.24

ATLANTIC CROSSINGS  
**CORAL SPRINGS, FL**  
 750-938 NORTH UNIVERSITY DRIVE



MetroCommercial.com