

DORAL, FL

DOWNTOWN DORAL

NW 53RD ST & NW 87TH AVE

±1,118 SF – 14,000 SF AVAILABLE FOR LEASE; GLA: ±230,000 SF

PHASE III EXPANSION TOTALING ±25,634 SF



Downtown Doral

JOIN



Publix
NEGRONI



Baptist
Health

UHealth
UNIVERSITY OF MIAMI HEALTH SYSTEM



© Tony Tur Photography

LEASED BY:



METRO[®]
COMMERCIAL
REAL ESTATE, INC.

DEVELOPED & MANAGED BY:

Codina
Partners

get in touch.

ALYONA TSUTSKOVA

office 786.671.4029
direct 786.470.4906
alyona@metrocommercial.com

YANINA YEFIMOVA

office 786.671.4020
direct 786.671.4027
yyefimova@metrocommercial.com

48,118 TOTAL HOUSEHOLDS WITHIN A 10 MINUTE DRIVE TIME

	1 Mile	3 Miles	10 Minutes
Total Population	16,504	106,660	136,724
Total Households	6,613	36,905	48,118
Med HH Income	\$68,785	\$68,680	\$67,218
% HH > \$100k	33%	34%	31%
Daytime Pop	40,762	226,574	249,170

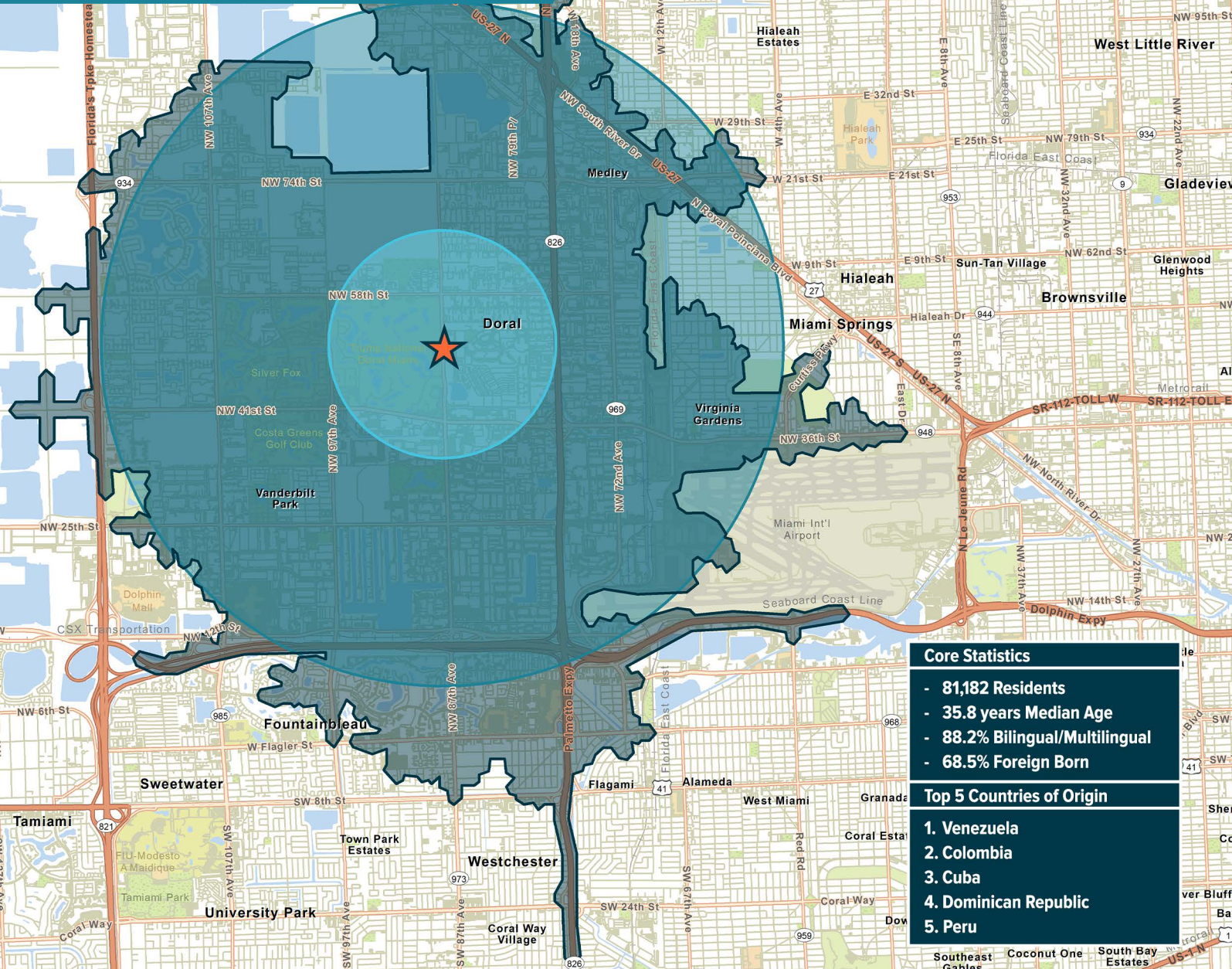

1 Mile
 3 Miles
 10 Minutes

Core Statistics

- 81,182 Residents
- 35.8 years Median Age
- 88.2% Bilingual/Multilingual
- 68.5% Foreign Born

Top 5 Countries of Origin

1. Venezuela
2. Colombia
3. Cuba
4. Dominican Republic
5. Peru

The information and images contained herein are from sources deemed reliable. However, Metro Commercial Real Estate, Inc. makes no representation whatsoever as to their accuracy or authenticity. Images shown may be modified for illustrative purposes. Images may be out-of-date and not current. 08.07.24

DORAL, FL
DOWNTOWN DORAL
 NW 53RD ST & NW 87TH AVE



MetroCommercial.com

COMPETITION AERIAL



The information and images contained herein are from sources deemed reliable. However, Metro Commercial Real Estate, Inc. makes no representation whatsoever as to their accuracy or authenticity. Images shown may be modified for illustrative purposes. Images may be out-of-date and not current. 06.07.24

DORAL, FL
DOWNTOWN DORAL
 NW 53RD ST & NW 87TH AVE



MetroCommercial.com

MASTER PLAN



**SINGLE-FAMILY
HOMES AND TOWNHOMES**



**DOWNTOWN DORAL
POCKET PARK**



**DOWNTOWN DORAL
PARK**



**UHEALTH DORAL
MEDICAL CENTER**



**DORAL CULTURAL
ARTS CENTER**



PUBLIX SUPERMARKET

The information and images contained herein are from sources deemed reliable. However, Metro Commercial Real Estate, Inc. makes no representation whatsoever as to their accuracy or authenticity. Images shown may be modified for illustrative purposes. Images may be out-of-date and not current. 08.07.24

DORAL, FL
DOWNTOWN DORAL
NW 53RD ST & NW 87TH AVE



[MetroCommercial.com](https://www.MetroCommercial.com)

RESIDENTIAL MARKET

7,000+ RESIDENTIAL UNITS

SINGLE FAMILY HOMES

1 CANARIAS
343 HOMES | \$870K - \$2M

TOWNHOMES

2 DOWNTOWN DORAL TOWNHOMES
80 HOMES | \$546K - \$990K

3 URBANA TOWNHOMES
528 UNITS | \$620K - \$930K

CONDOMINIUMS

4 5252 PASEO
203 UNITS | \$330K - \$710K

5 5300 PASEO
219 UNITS | \$360K - \$860K

6 5350 PARK
238 UNITS | \$345K - \$790K

7 URBANA RESIDENCES
900 UNITS | \$380K - \$575K

8 DORAL COURT
368 UNITS | \$318K - \$337K

9 SANDORAL CONDOMINIUM
541 UNITS | \$239K - \$313K

10 DORAL GARDENS
836 UNITS | \$260K - 380K

11 DORAL GARDENS II
385 UNITS | \$349K

12 LAS VISTAS AT DORAL
969 UNITS | \$273K - 349K

RENTAL APARTMENTS

13 PALMA TOWER
231 UNITS | \$2,717 - \$3,815/MONTH

14 PALMA TOWER 2
228 UNITS | \$2,283 - \$5,030/MONTH

15 CORDOBA 1
224 UNITS | \$2,332 - \$4,153/MONTH

16 CORDOBA 2
232 UNITS | \$2,332 - \$4,153/MONTH

17 CENTRICO BY WINDSOR
385 UNITS | \$2,485 - \$5,576/MONTH

18 OVERTURE DORAL (55+)
198 UNITS | \$2,280 - \$4,140/MONTH

19 GRAN VISTA
146 UNITS | \$2,202 - \$3,400/MONTH

20 WINDSOR AT DORAL
249 UNITS | \$2,670 - \$4,130/MONTH

21 AVALON DORAL
350 UNITS | \$2,240 - \$3,895/MONTH

HOTELS

22 MARRIOTT'S VILLAS
141 ROOMS | \$328 - \$405/NIGHT

23 TRUMP NATIONAL
DORAL RESORT
643 ROOMS | \$314 - \$669/NIGHT

24 FAIRFIELD INN & SUITES
133 ROOMS | \$132 - \$232/NIGHT

25 AC HOTEL
118 ROOMS | \$157 - \$238/NIGHT

26 PROVIDENT DORAL
200 ROOMS | \$165 - \$176/NIGHT

FUTURE DEVELOPMENTS

27 THE DORI BY QUARTERRA
222 UNITS

28 SEVILLA
MULTIFAMILY BUILDING | 412 UNITS



The information and images contained herein are from sources deemed reliable. However, Metro Commercial Real Estate, Inc. makes no representation whatsoever as to their accuracy or authenticity. Images shown may be modified for illustrative purposes. Images may be out-of-date and not current. 08.07.24

DORAL, FL
DOWNTOWN DORAL
NW 53RD ST & NW 87TH AVE



MetroCommercial.com

COMMERCIAL MARKET

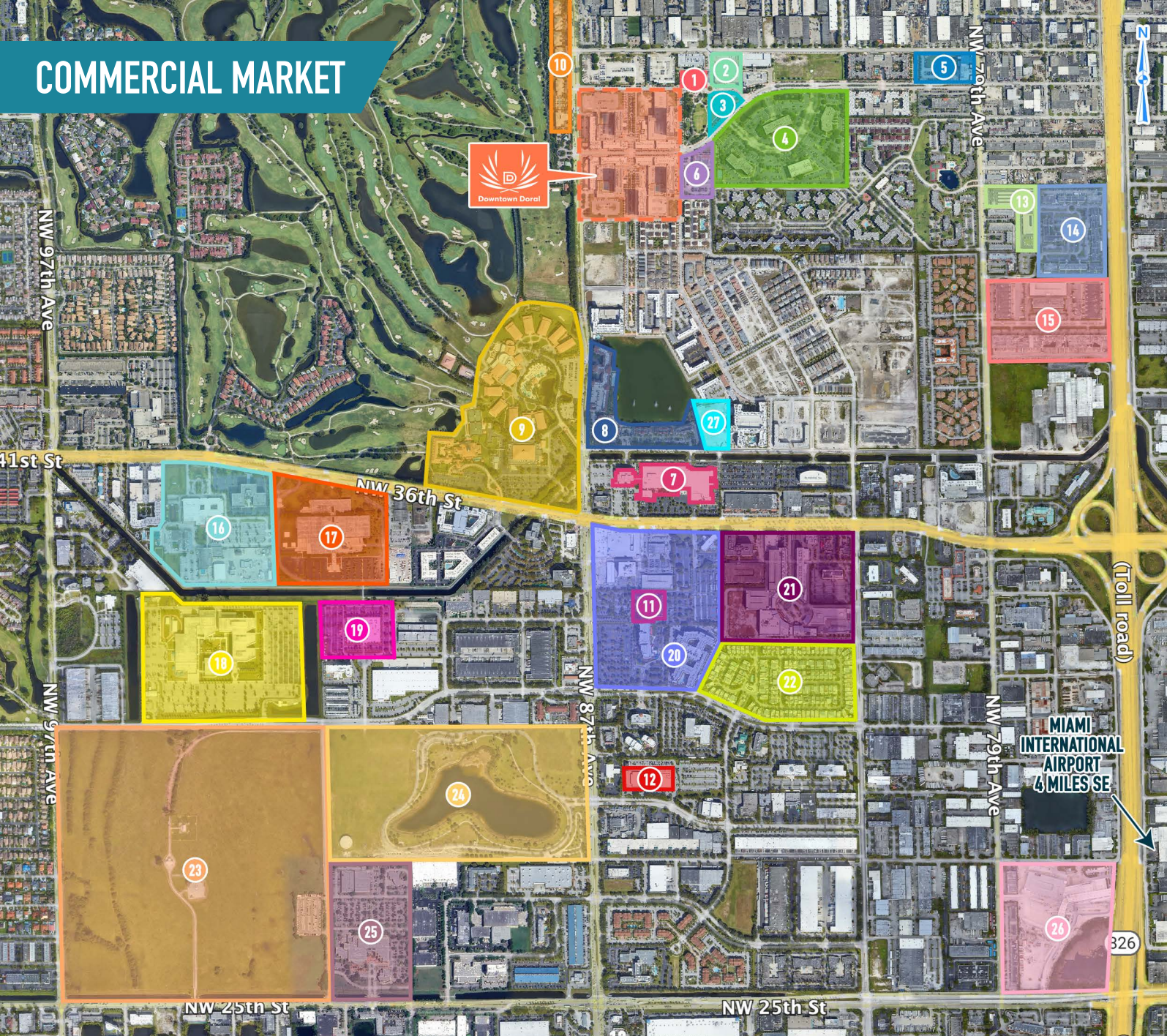

- 1 CITY HALL
- 2 UHEALTH DORAL MEDICAL CENTER
- 3 DORAL CULTURAL ARTS CENTER
- 4 OFFICE PARK (FUTURE RESIDENTIAL)
- 5 CHARTER UPPER SCHOOL
- 6 CHARTER ELEMENTARY SCHOOL
- 7 LEON HEALTH HQ
- 8 MARRIOTT VILLAS
- 9 TRUMP NATIONAL DORAL RESORT
- 10 PROVIDENT DORAL
- 11 CARNIVAL CRUISE HEADQUARTERS
- 12 UNIVISION DORAL
- 13 EXTRA SPACE STORAGE
- 14 CORPORATE PARK
- 15 PALMETTO WEST PARK II
- 16 MIAMI-DADE FIRE DEPARTMENT
- 17 FEDERAL RESERVE BANK OF AMERICA - MIAMI BRANCH
- 18 U.S. SOUTHERN COMMAND
- 19 MIAMI HERALD MEDIA
- 20 DORAL SQUARE
- 21 CITYPLACE DORAL
- 22 OASIS CONDOS
- 23 DOLPHIN VOR-DHP MIAMI INTL AIRPORT RADIO TOWER
- 24 DORAL CENTRAL PARK
- 25 MIAMI-DADE POLICE DEPARTMENT
- 26 JACKSON WEST MEDICAL CENTER
- 27 WHITE COURSE PARK

The information and images contained herein are from sources deemed reliable. However, Metro Commercial Real Estate, Inc. makes no representation whatsoever as to their accuracy or authenticity. Images shown may be modified for illustrative purposes. Images may be out-of-date and not current. 08.07.24

DORAL, FL
DOWNTOWN DORAL
 NW 53RD ST & NW 87TH AVE



MetroCommercial.com

RETAIL AERIAL



The information and images contained herein are from sources deemed reliable. However, Metro Commercial Real Estate, Inc. makes no representation whatsoever as to their accuracy or authenticity. Images shown may be modified for illustrative purposes. Images may be out-of-date and not current. 08.07.24

DORAL, FL
DOWNTOWN DORAL
 NW 53RD ST & NW 87TH AVE



MetroCommercial.com

OVERALL SITE PLAN



The information and images contained herein are from sources deemed reliable. However, Metro Commercial Real Estate, Inc. makes no representation whatsoever as to their accuracy or authenticity. Images shown may be modified for illustrative purposes. Images may be out-of-date and not current. 08.07.24

DORAL, FL
DOWNTOWN DORAL
 NW 53RD ST & NW 87TH AVE



MetroCommercial.com



FUTURE RETAIL - FIRST LEVEL

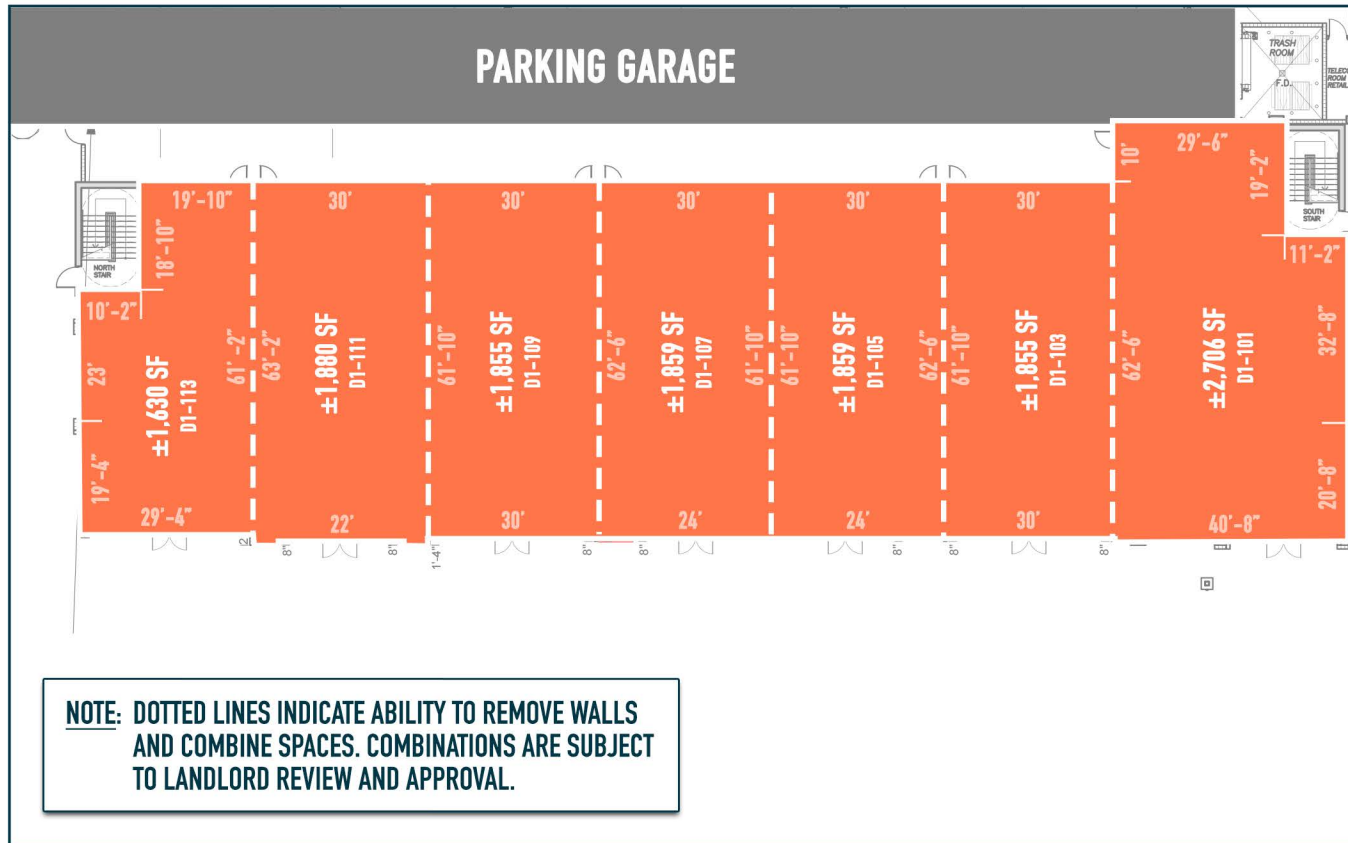

The information and images contained herein are from sources deemed reliable. However, Metro Commercial Real Estate, Inc. makes no representation whatsoever as to their accuracy or authenticity. Images shown may be modified for illustrative purposes. Images may be out-of-date and not current. 08.07.24



FUTURE RETAIL - SECOND LEVEL

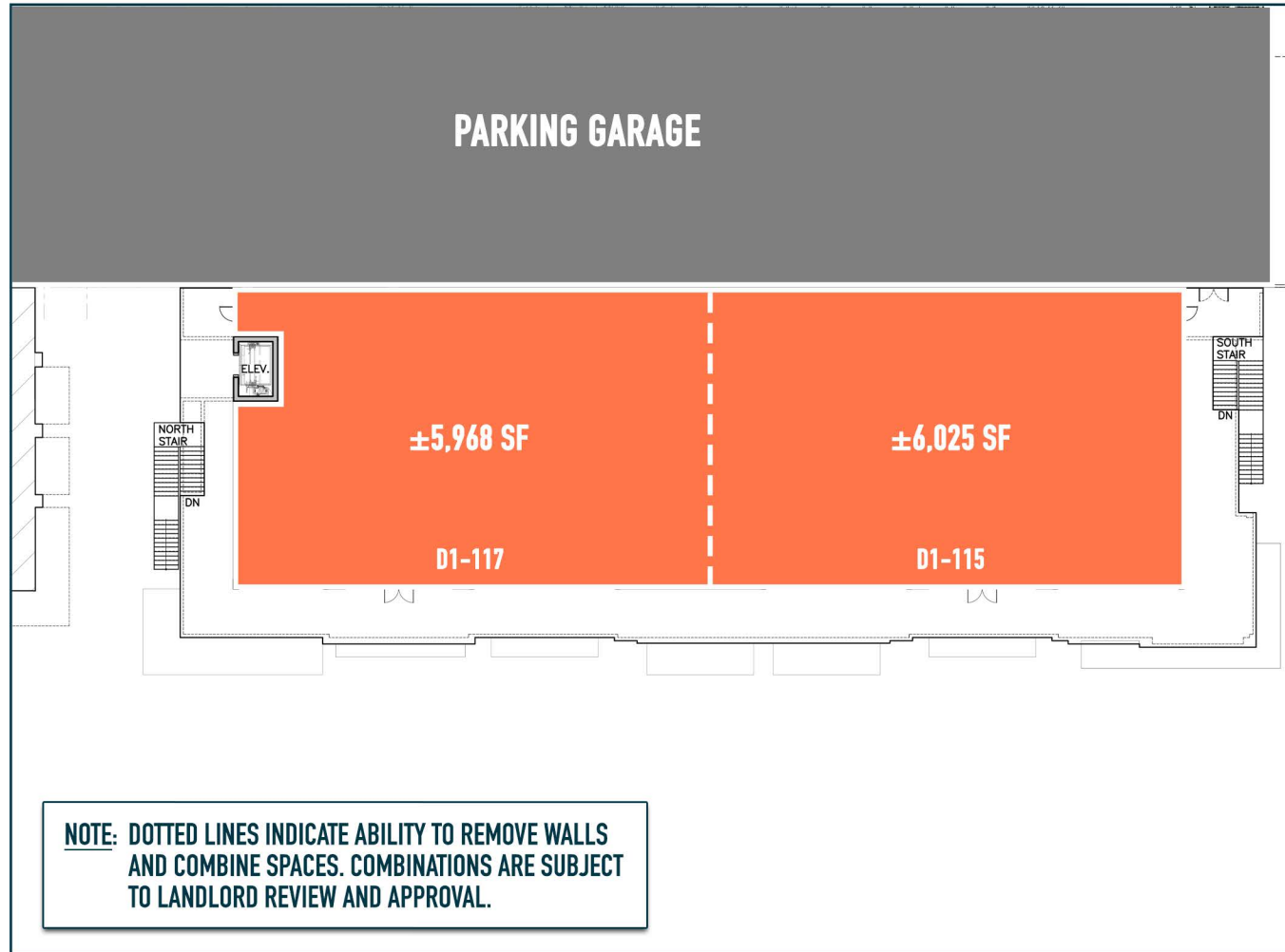

The information and images contained herein are from sources deemed reliable. However, Metro Commercial Real Estate, Inc. makes no representation whatsoever as to their accuracy or authenticity. Images shown may be modified for illustrative purposes. Images may be out-of-date and not current. 08.07.24

PHASE III EXPANSION TOTALING ±25,634 SF ACROSS TWO LEVELS

PROJECTED DELIVERY Q3 2025

SOUTH:



The information and images contained herein are from sources deemed reliable. However, Metro Commercial Real Estate, Inc. makes no representation whatsoever as to their accuracy or authenticity. Images shown may be modified for illustrative purposes. Images may be out-of-date and not current. 08.07.24

DORAL, FL
DOWNTOWN DORAL
NW 53RD ST & NW 87TH AVE



MetroCommercial.com

PHOTOS



The information and images contained herein are from sources deemed reliable. However, Metro Commercial Real Estate, Inc. makes no representation whatsoever as to their accuracy or authenticity. Images shown may be modified for illustrative purposes. Images may be out-of-date and not current. 08.07.24

DORAL, FL
DOWNTOWN DORAL
NW 53RD ST & NW 87TH AVE



MetroCommercial.com

PHOTOS



The information and images contained herein are from sources deemed reliable. However, Metro Commercial Real Estate, Inc. makes no representation whatsoever as to their accuracy or authenticity. Images shown may be modified for illustrative purposes. Images may be out-of-date and not current. 08.07.24

DORAL, FL
DOWNTOWN DORAL
NW 53RD ST & NW 87TH AVE