

FORMER RITE AID
PHILADELPHIA, PA

4011 COTTMAN AVENUE

±14,700 SF GROUND FLOOR WITH ±1,440 SF MEZZANINE OFFICE AVAILABLE FOR LEASE

PHILADELPHIA MSA

**JUNIOR BOX
OPPORTUNITY!**

RARE JUNIOR BOX SPACE IN NORTHEAST PHILADELPHIA



MetroCommercial.com | PLYMOUTH MEETING, PA | MOUNT LAUREL, NJ | MIAMI, FL | PHILADELPHIA, PA

get in touch.

JONATHAN SPOERL

office 215.893.0300
direct 215.282.0157
jspoerl@metrocommercial.com

DAVID JUDD

office 856.866.1900
direct 856.222.3037
djudd@metrocommercial.com

260,515 TOTAL HOUSEHOLDS WITHIN A 10 MINUTE DRIVE TIME

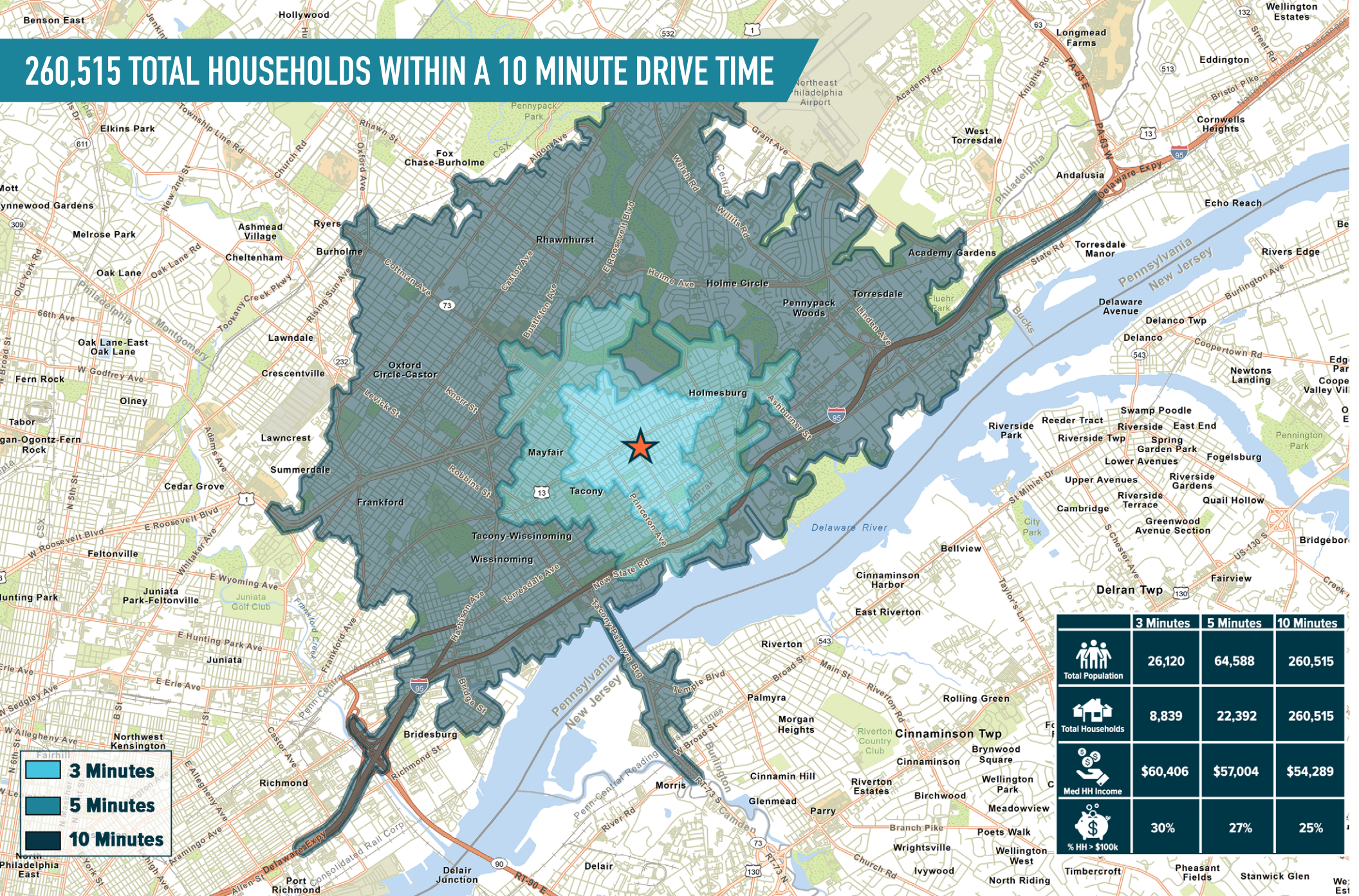

3 Minutes
 5 Minutes
 10 Minutes

	3 Minutes	5 Minutes	10 Minutes
Total Population	26,120	64,588	260,515
Total Households	8,839	22,392	260,515
Med HH Income	\$60,406	\$57,004	\$54,289
% HH > \$100k	30%	27%	25%

The information and images contained herein are from sources deemed reliable. However, Metro Commercial Real Estate, Inc. makes no representation whatsoever as to their accuracy or authenticity. Images shown may be modified for illustrative purposes. Images may be out-of-date and not current. 12.20.23

FORMER RITE AID
PHILADELPHIA, PA
4011 COTTMAN AVENUE

STRONG HISTORICAL DATA OF HIGH CUSTOMER TRAFFIC ON SITE

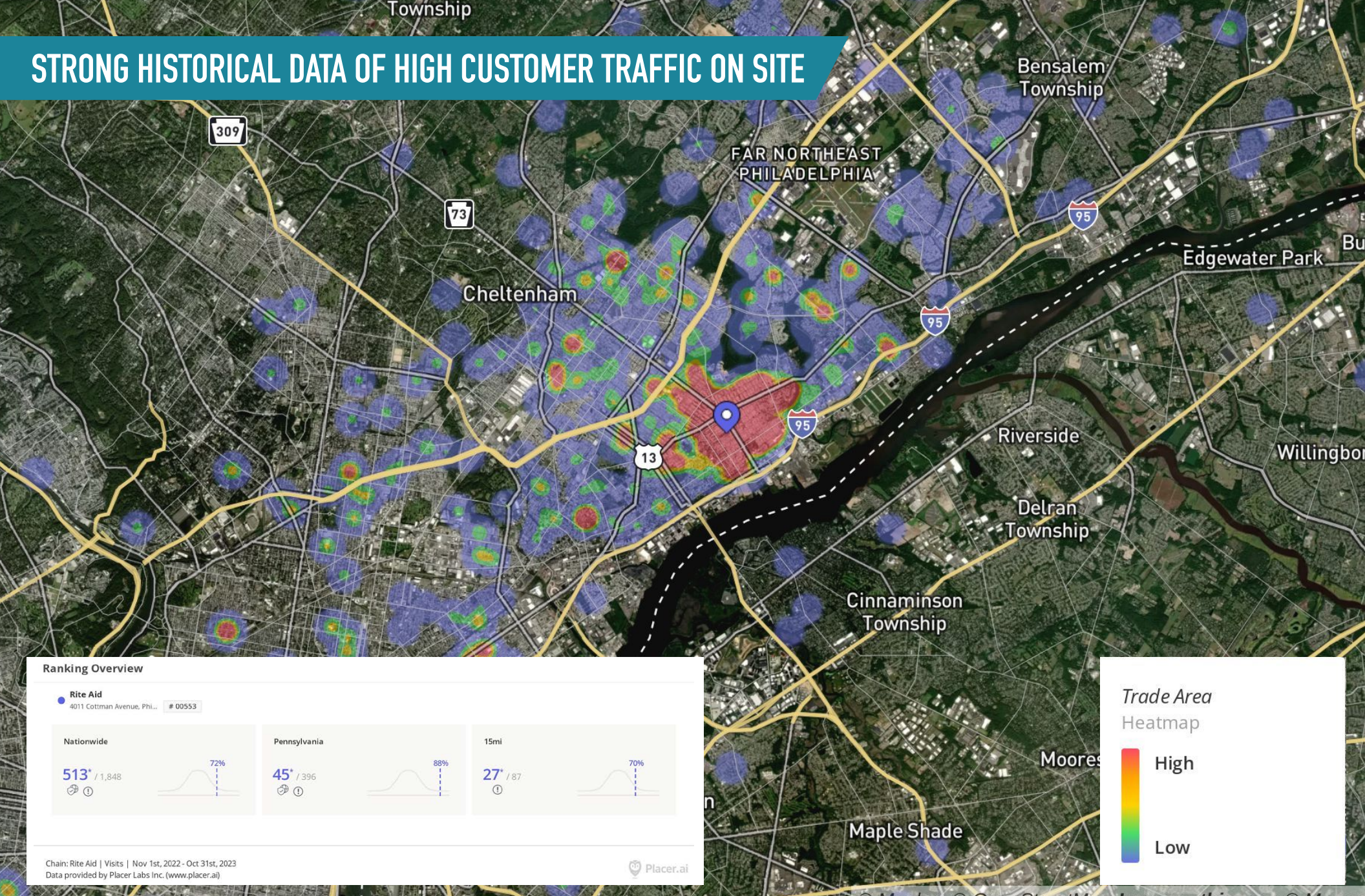

Ranking Overview

Rite Aid
4011 Cottman Avenue, Phi... # 00553

Nationwide

513* / 1,848



Pennsylvania

45* / 396



15mi

27* / 87



Chain: Rite Aid | Visits | Nov 1st, 2022 - Oct 31st, 2023
Data provided by Placer Labs Inc. (www.placer.ai)



Trade Area
Heatmap

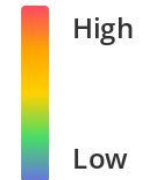

© Mapbox © OpenStreetMap Improve this map © Maxar

FORMER RITE AID
PHILADELPHIA, PA
4011 COTTMAN AVENUE



MetroCommercial.com

The information and images contained herein are from sources deemed reliable. However, Metro Commercial Real Estate, Inc. makes no representation whatsoever as to their accuracy or authenticity. Images shown may be modified for illustrative purposes. Images may be out-of-date and not current. 12.20.23

WELL POSITIONED JUNIOR BOX WITHIN DENSE NEIGHBORHOOD OF NE PHILADELPHIA



COTTMAN & CASTOR SHOPPING CENTER
TJ-maxx
ACME GIANT
Curlington
 Raymour & Flanigan
five BELOW **Party City**

target
PETSMART
PEPBOYS AUTO

NORTHEAST TOWER CENTER
Walmart
PETSMART
ROSS
 Raymour & Flanigan
Staples
DOLLAR TREE

Roosevelt Mall
macy's **ROSS**
xfinity **the Vitamin Shoppe**
snipes **JD** **THE CHILDREN'S PLACE**
NEW YORK & COMPANY

MAYFAIR MARKET
planet fitness
DOLLAR TREE
FAMILY DOLLAR

The information and images contained herein are from sources deemed reliable. However, Metro Commercial Real Estate, Inc. makes no representation whatsoever as to their accuracy or authenticity. Images shown may be modified for illustrative purposes. Images may be out-of-date and not current. 12.20.23

FORMER RITE AID
PHILADELPHIA, PA
 4011 COTTMAN AVENUE



MetroCommercial.com

LOCATED ON THE HARD CORNER OF FRANKFORD & COTTMAN WITH 52 PARKING SPACES

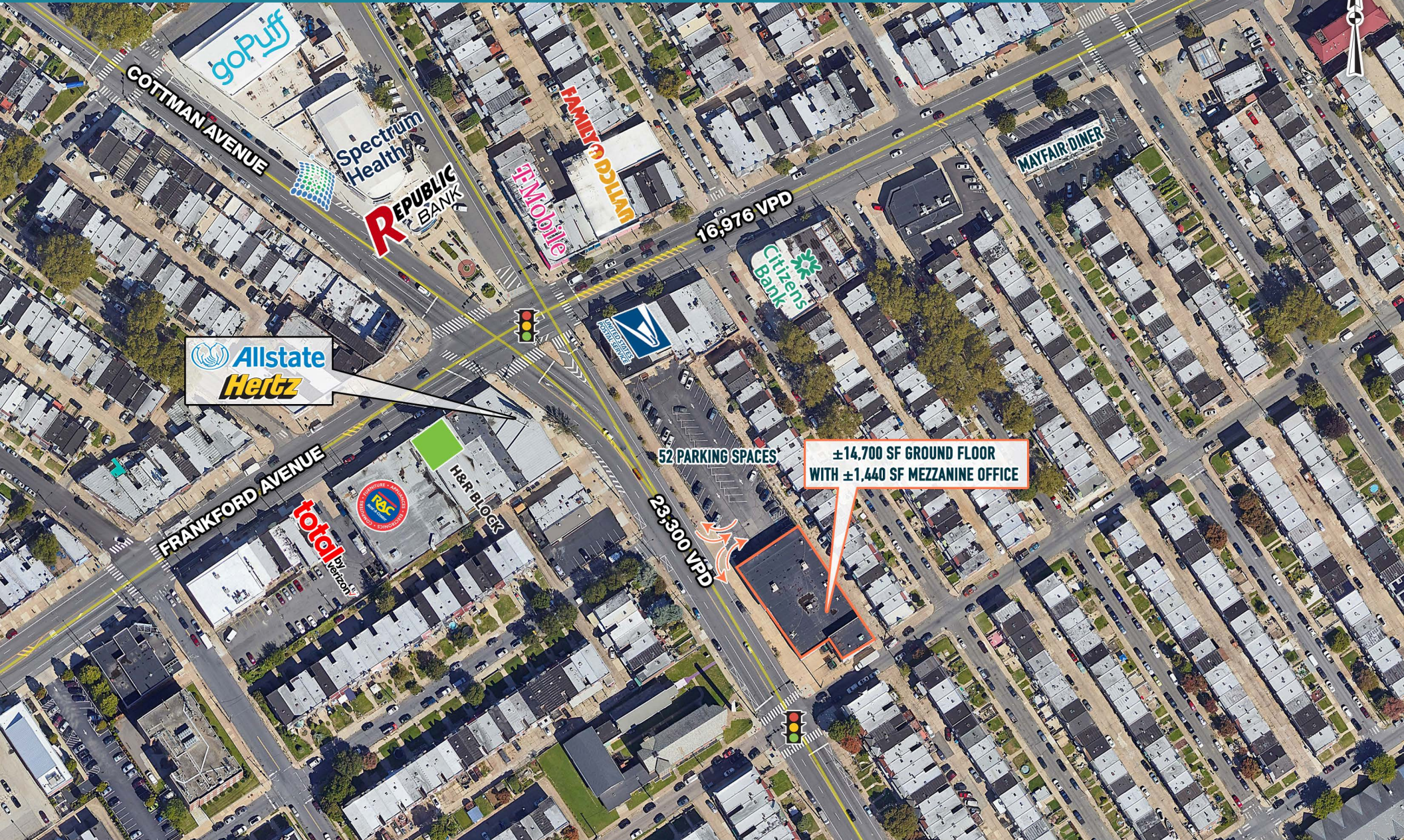

The information and images contained herein are from sources deemed reliable. However, Metro Commercial Real Estate, Inc. makes no representation whatsoever as to their accuracy or authenticity. Images shown may be modified for illustrative purposes. Images may be out-of-date and not current. 12.20.23

FORMER RITE AID
PHILADELPHIA, PA
4011 COTTMAN AVENUE



MetroCommercial.com

FLOOR PLAN

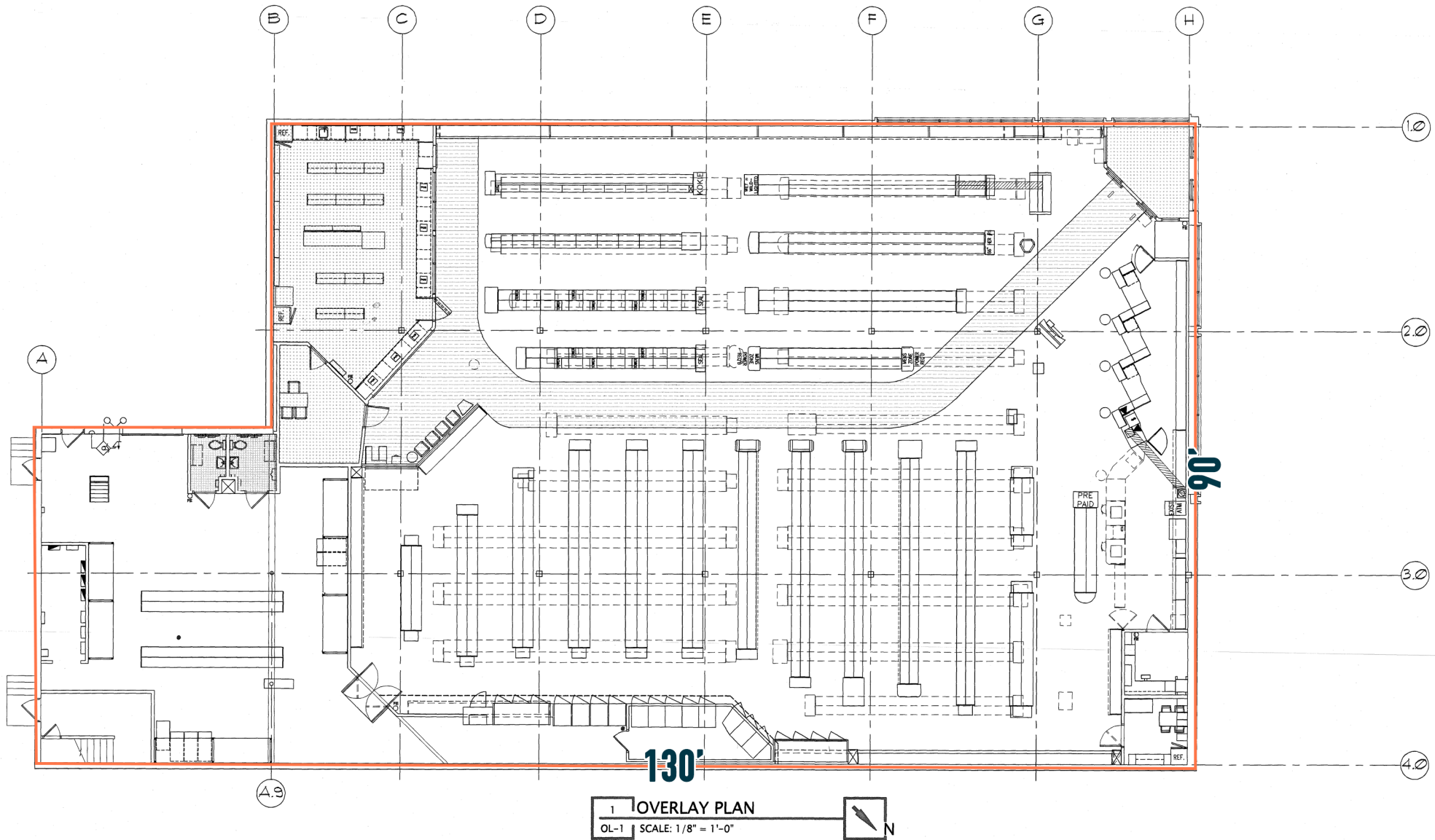

The information and images contained herein are from sources deemed reliable. However, Metro Commercial Real Estate, Inc. makes no representation whatsoever as to their accuracy or authenticity. Images shown may be modified for illustrative purposes. Images may be out-of-date and not current. 12.20.23

FORMER RITE AID
PHILADELPHIA, PA
4011 COTTMAN AVENUE



MetroCommercial.com