

# 700 DELAWARE AVENUE

NORTHERN LIBERTIES  
PHILADELPHIA, PA  
DELIVERY FALL 2024

get in touch.

## MICHAEL GORMAN

office 215.893.0300

direct 215.282.0152

mgorman@metrocommercial.com

## SCOTT BENSON

office 215.893.0300

direct 215.282.0158

sbenson@metrocommercial.com

**SAXUM**  
REAL ESTATE



**METRO**<sup>®</sup>  
COMMERCIAL  
REAL ESTATE, INC.



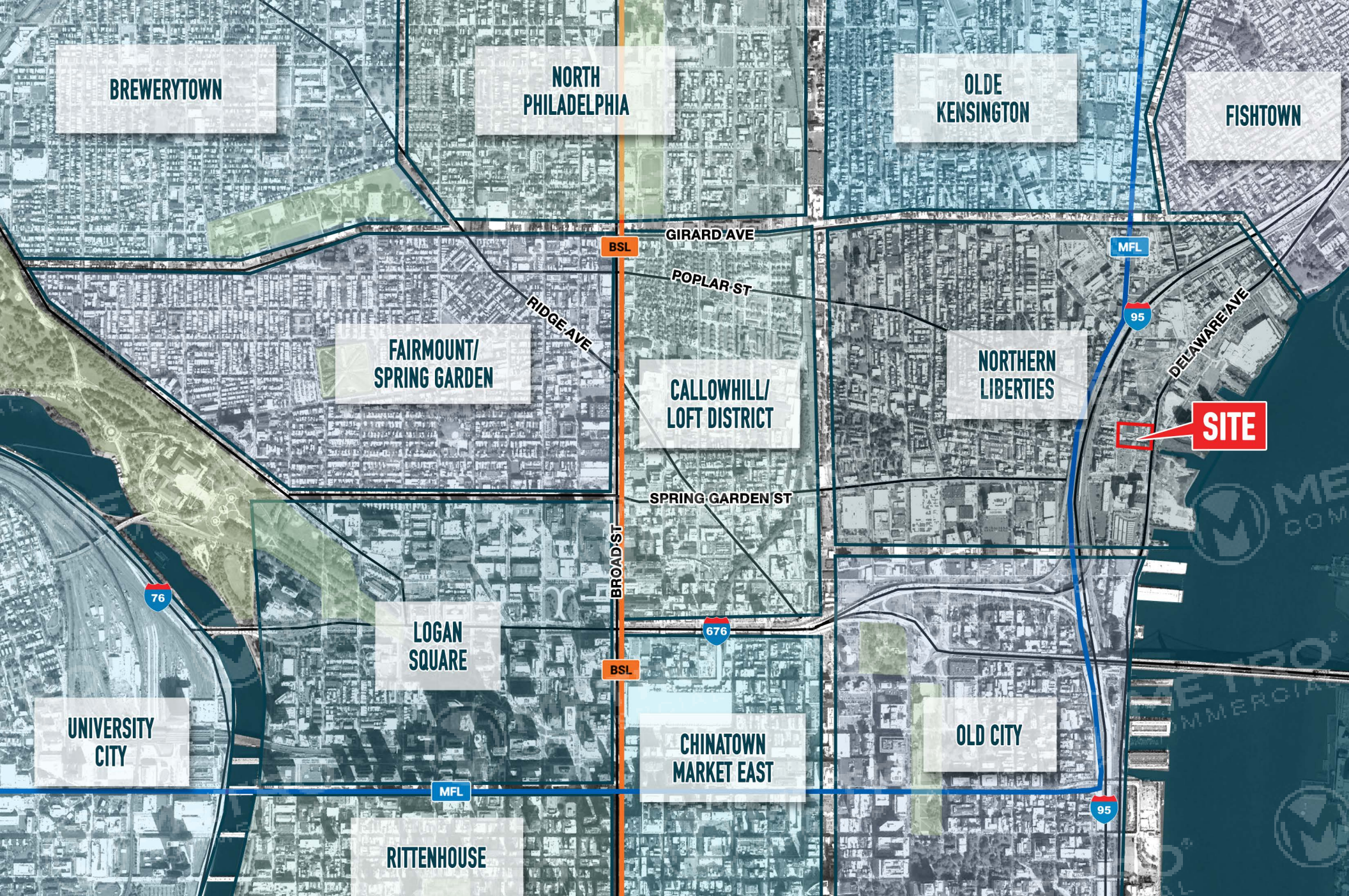

**BREWERYTOWN**

**NORTH PHILADELPHIA**

**OLDE KENSINGTON**

**FISHTOWN**

**FAIRMOUNT/  
SPRING GARDEN**

**CALLOWHILL/  
LOFT DISTRICT**

**NORTHERN  
LIBERTIES**

**SITE**

**LOGAN  
SQUARE**

**UNIVERSITY  
CITY**

**RITTENHOUSE**

**CHINATOWN  
MARKET EAST**

**OLD CITY**

**700 DELAWARE AVENUE  
PHILADELPHIA, PA**



The information and images contained herein are from sources deemed reliable. However, Metro Commercial Real Estate, Inc. makes no representation whatsoever as to their accuracy or authenticity. Images shown may be modified for illustrative purposes. Images may be out-of-date and not current. 5.12.21



# 700 DELAWARE AVENUE

Saxum Real Estate and Metro Commercial are proud to present a number of unique retail opportunities within Saxum's new 466-unit Northern Liberties development. 700 Delaware is located in the booming Northern Liberties neighborhood of Philadelphia and is strategically positioned along the Delaware River. The project's unique design creates several prominent branding and locational advantages for retailers looking to position themselves in one of the fastest growing neighborhoods in Philadelphia. The project is comprised of two mixed use buildings with a pedestrian-only cobblestone thoroughfare running through the center of the project, which will become Northern Liberties' newest restaurant and lifestyle row.



The information and images contained herein are from sources deemed reliable. However, Metro Commercial Real Estate, Inc. makes no representation whatsoever as to their accuracy or authenticity. Images shown may be modified for illustrative purposes. Images may be out-of-date and not current. 5.12.21

**700 DELAWARE AVENUE  
PHILADELPHIA, PA**



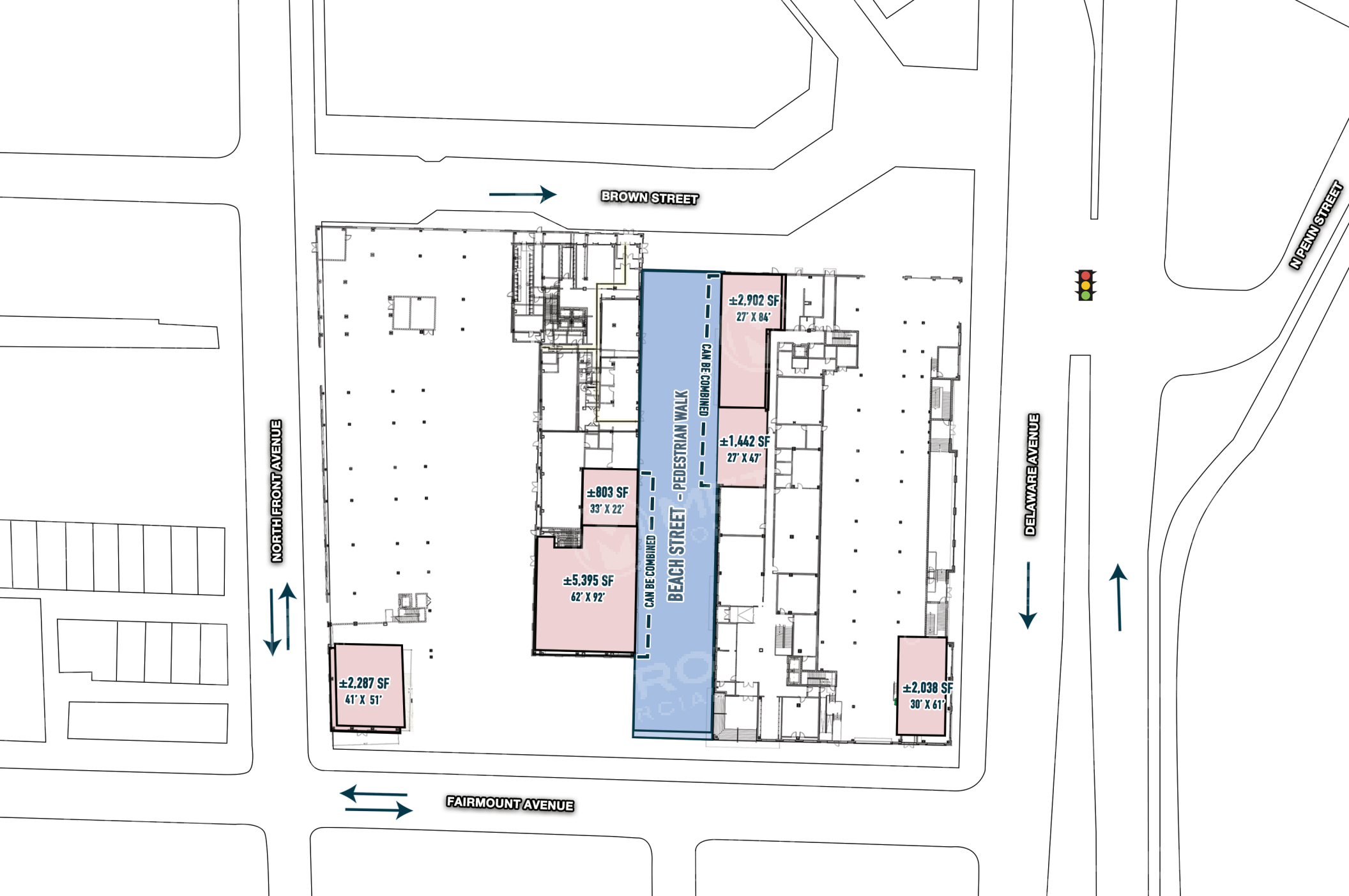

The information and images contained herein are from sources deemed reliable. However, Metro Commercial Real Estate, Inc. makes no representation whatsoever as to their accuracy or authenticity. Images shown may be modified for illustrative purposes. Images may be out-of-date and not current. 5.12.21

**700 DELAWARE AVENUE  
PHILADELPHIA, PA**





# NOTABLE RETAIL & RESTAURANTS

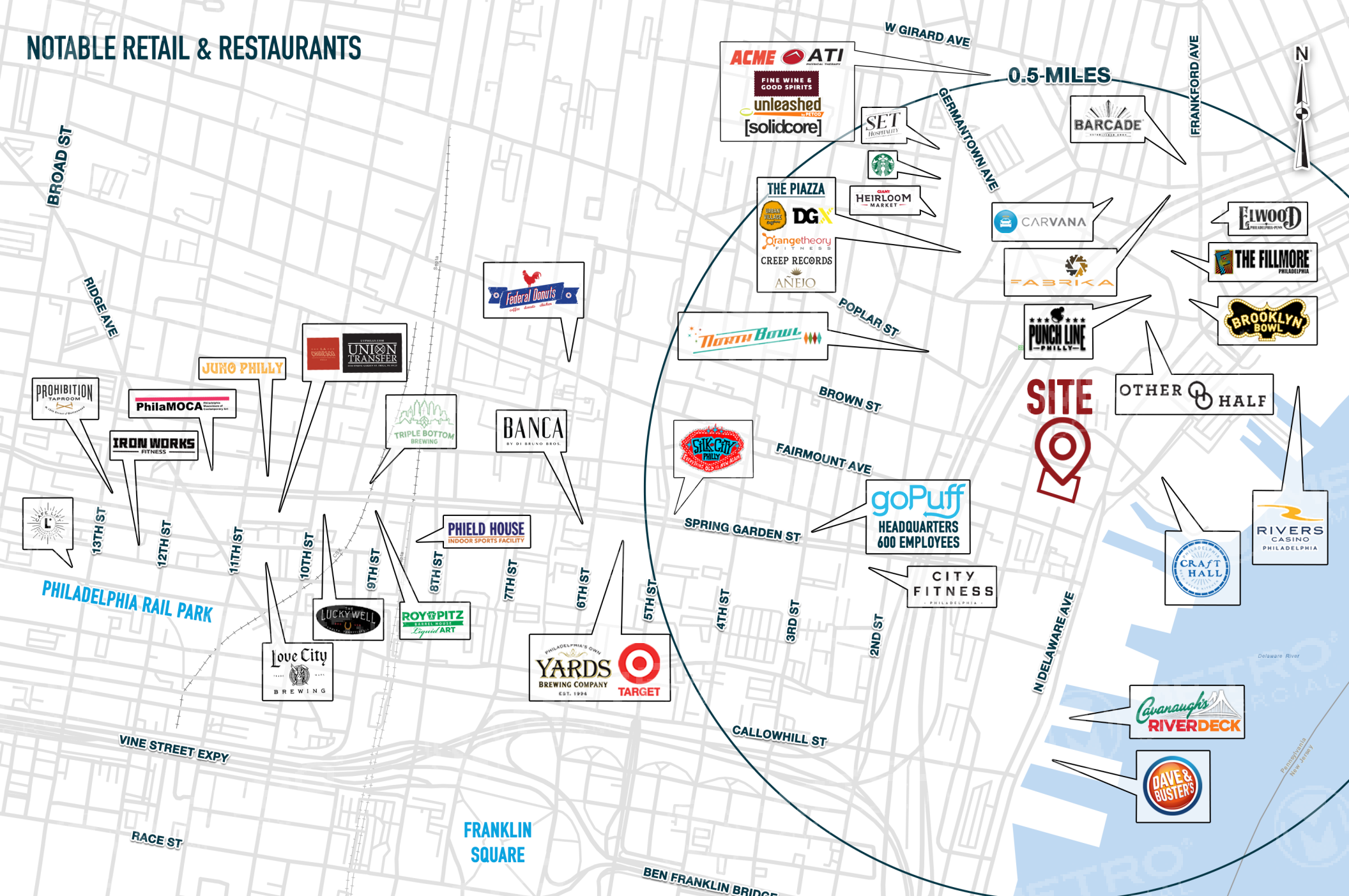

The information and images contained herein are from sources deemed reliable. However, Metro Commercial Real Estate, Inc. makes no representation whatsoever as to their accuracy or authenticity. Images shown may be modified for illustrative purposes. Images may be out-of-date and not current. 5.12.21

**700 DELAWARE AVENUE  
PHILADELPHIA, PA**





# NOTABLE SURROUNDING MULTIFAMILY RESIDENTIAL

## NOTABLE EXISTING RESIDENTIAL

1	Goldtex Apartments	163 Units
2	Liberties West Condos	172 Units
3	Fairmount Manor Apartments	107 Units
4	Waterfront Square	484 Units
5	1 Brown Street	224 Units
6	The Piazza	656 Units
7	The Chocolate Works	135 Units
8	York Square	60 Units
9	444 Lofts	136 Units

## PROPOSED/UNDER CONSTRUCTION RESIDENTIAL

1	700 Delaware Avenue	482 Units
2	412 North 2nd Street	397 Units
3	New Fairmount Manor	404 Units
4	1100 Delaware Avenue	169 Units
5	1130-1154 N Delaware Avenue	249 Units
6	The Poplar	350 Units
7	8th & Spring Garden Street	146 Units
8	5th & Callowhill Street	220 Units
9	SoNo	49 Units
10	741 Spring Garden Street	146 Units
11	Festival Pier Apartments	550 Units
12	918-980 Delaware Avenue	462 Units
13	Welhaus	500 Units
14	Piazza Terminal	1,100 Units
15	1102 Germantown Avenue	169 Units
16	1075 Germantown Avenue	697 Units
17	1201 Spring Garden Street	46 Units
18	418 Spring Garden Street	329 Units
19	200 Spring Garden Street	355 Units

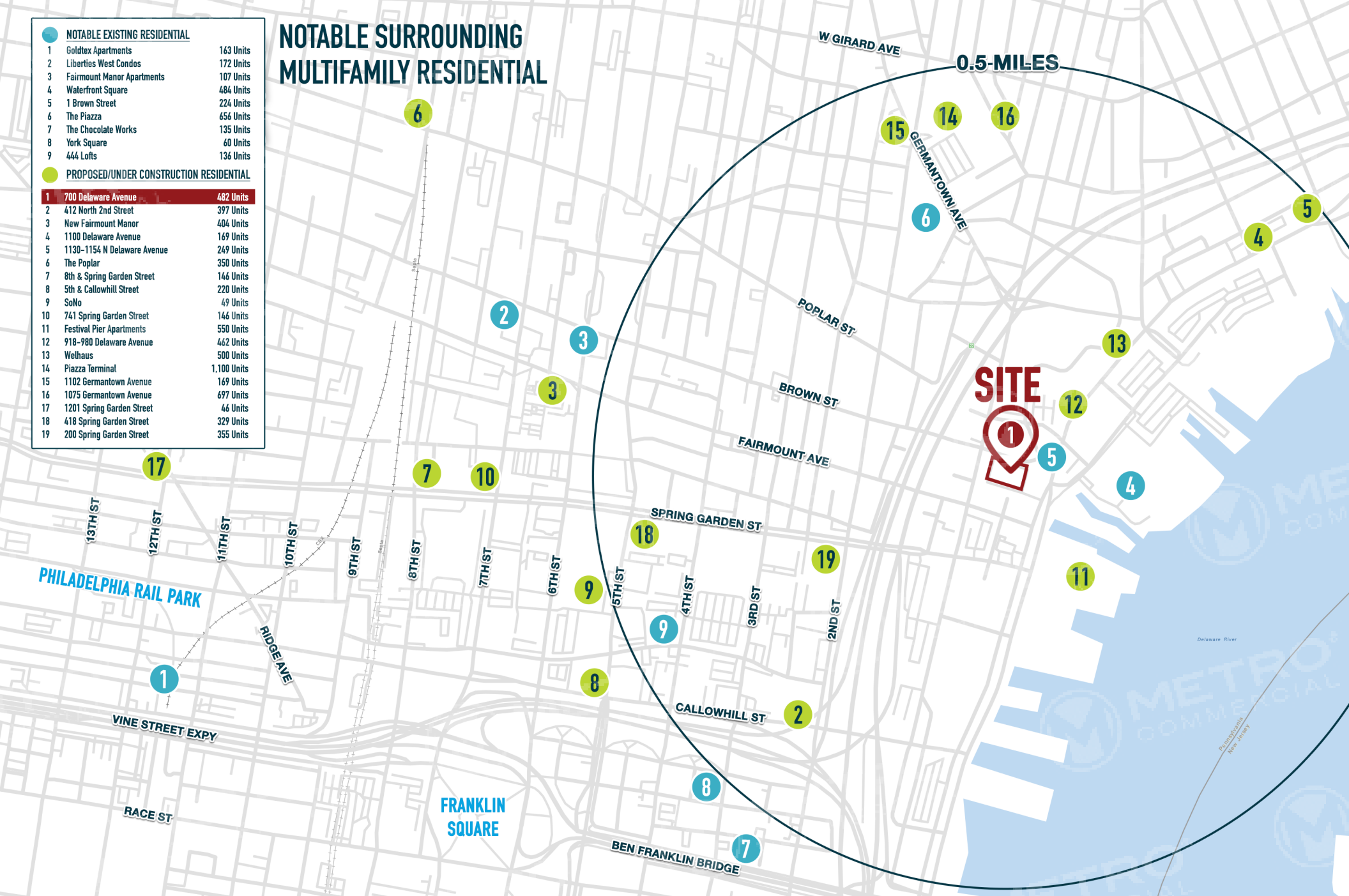

The information and images contained herein are from sources deemed reliable. However, Metro Commercial Real Estate, Inc. makes no representation whatsoever as to their accuracy or authenticity. Images shown may be modified for illustrative purposes. Images may be out-of-date and not current. 5.12.21

**700 DELAWARE AVENUE  
PHILADELPHIA, PA**







The information and images contained herein are from sources deemed reliable. However, Metro Commercial Real Estate, Inc. makes no representation whatsoever as to their accuracy or authenticity. Images shown may be modified for illustrative purposes. Images may be out-of-date and not current.5.12.21

**700 DELAWARE AVENUE  
PHILADELPHIA, PA**

