

NANTICOKE CROSSING
MILLSBORO, DE

24832 JOHN J. WILLIAMS HIGHWAY

±2,400 SF ENDCAP AVAILABLE FOR LEASE

JOIN

weis

LAST REMAINING SPACE AVAILABLE AT WEIS MARKETS GROCERY-ANCHORED CENTER



get in touch.

GLENN MARVIN

office 610.825.5222

direct 610.260.2674

gmarvin@metrocommercial.com

22,586 TOTAL HOUSEHOLDS WITHIN A 15 MINUTE DRIVE TIME

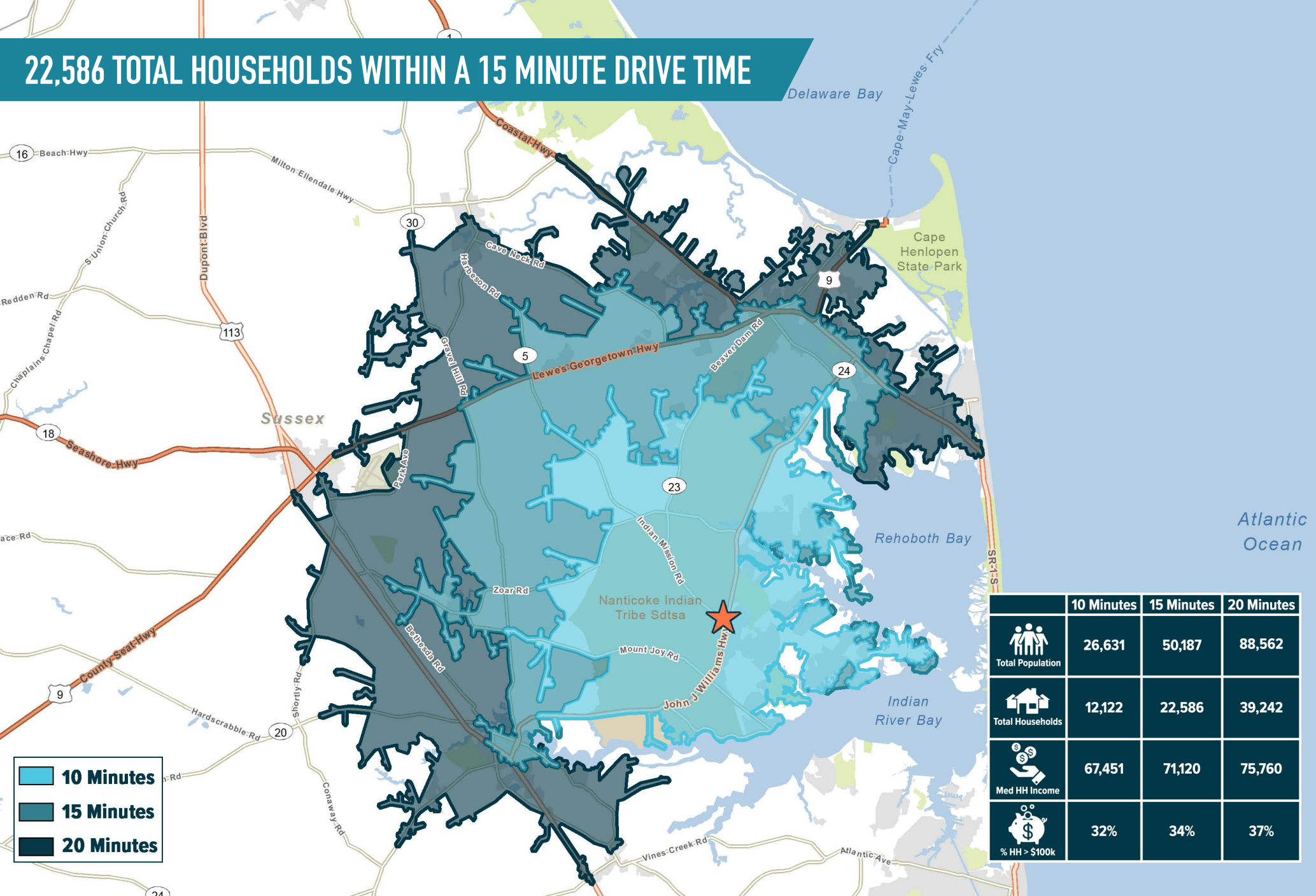

The information and images contained herein are from sources deemed reliable. However, Metro Commercial Real Estate, Inc. makes no representation whatsoever as to their accuracy or authenticity. Images shown may be modified for illustrative purposes. Images may be out-of-date and not current. 02.03.25

**NANTICOKE CROSSING
MILLSBORO, DE**
24832 JOHN J. WILLIAMS HIGHWAY



MetroCommercial.com

GROCERY ANCHORED SHOPPING CENTER WITH VISIBILITY ON JOHN J. WILLIAMS HIGHWAY

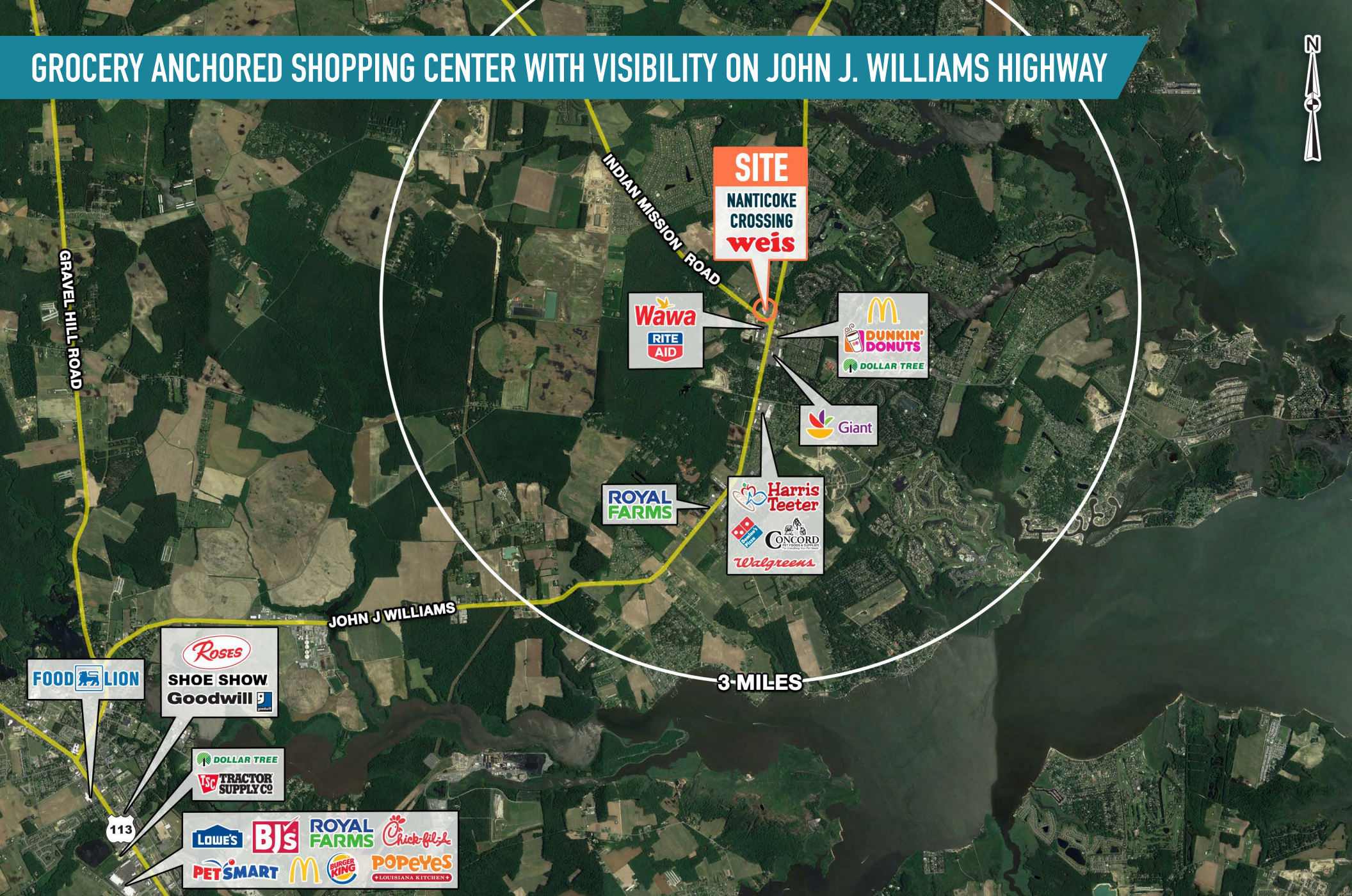

NANTICOKE CROSSING
MILLSBORO, DE
24832 JOHN J. WILLIAMS HIGHWAY



MetroCommercial.com

The information and images contained herein are from sources deemed reliable. However, Metro Commercial Real Estate, Inc. makes no representation whatsoever as to their accuracy or authenticity. Images shown may be modified for illustrative purposes. Images may be out-of-date and not current. 02.03.25

AREA RETAILERS INCLUDE RITE AID, WAWA & MCDONALD'S

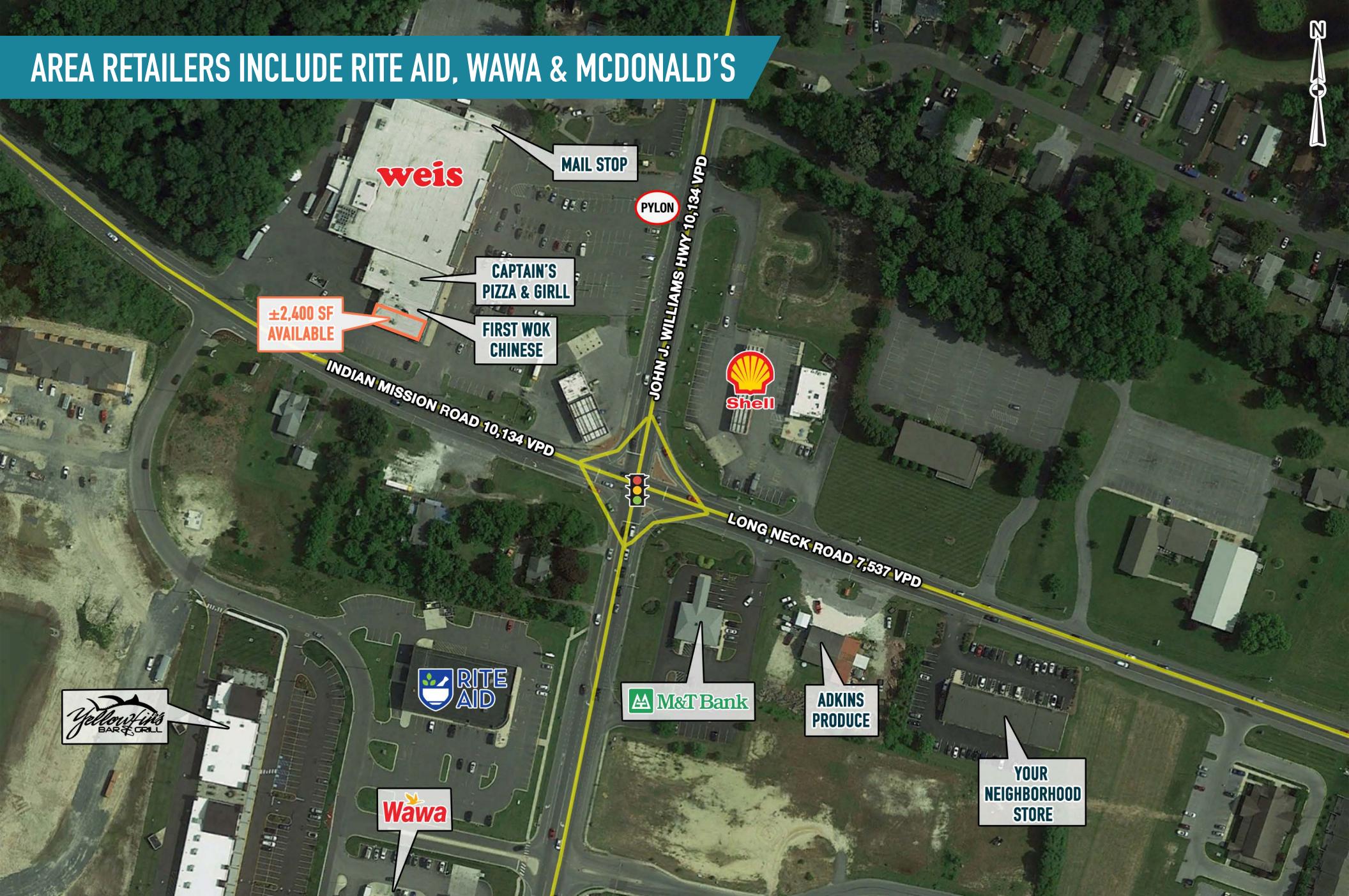

±2,400 SF AVAILABLE

weis

MAIL STOP

PYLON

CAPTAIN'S PIZZA & GIRL

FIRST WOK CHINESE

Shell

JOHN J. WILLIAMS HWY-10,134 VPD

INDIAN MISSION ROAD 10,134 VPD

LONG NECK ROAD 7,537 VPD

Yellowfin's
BAR & GRILL

RITE AID

M&T Bank

ADKINS PRODUCE

Wawa

YOUR NEIGHBORHOOD STORE

The information and images contained herein are from sources deemed reliable. However, Metro Commercial Real Estate, Inc. makes no representation whatsoever as to their accuracy or authenticity. Images shown may be modified for illustrative purposes. Images may be out-of-date and not current. 02.03.25

NANTICOKE CROSSING
MILLSBORO, DE
24832 JOHN J. WILLIAMS HIGHWAY



MetroCommercial.com

±2,400 SF ENDCAP AVAILABLE FOR LEASE

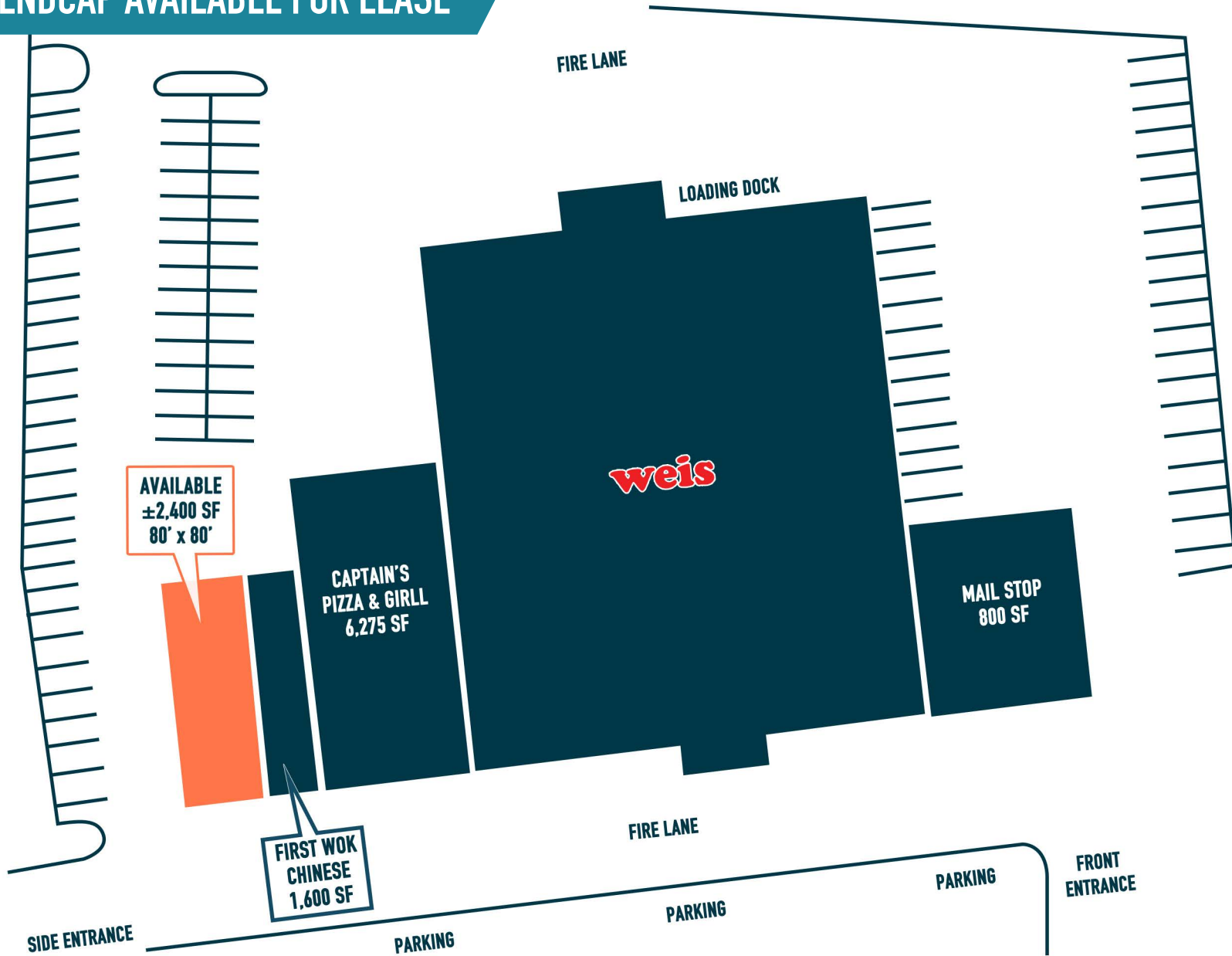

The information and images contained herein are from sources deemed reliable. However, Metro Commercial Real Estate, Inc. makes no representation whatsoever as to their accuracy or authenticity. Images shown may be modified for illustrative purposes. Images may be out-of-date and not current. 02.03.25

NANTICOKE CROSSING
MILLSBORO, DE
24832 JOHN J. WILLIAMS HIGHWAY



MetroCommercial.com

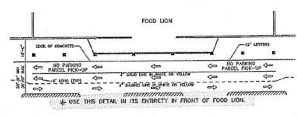
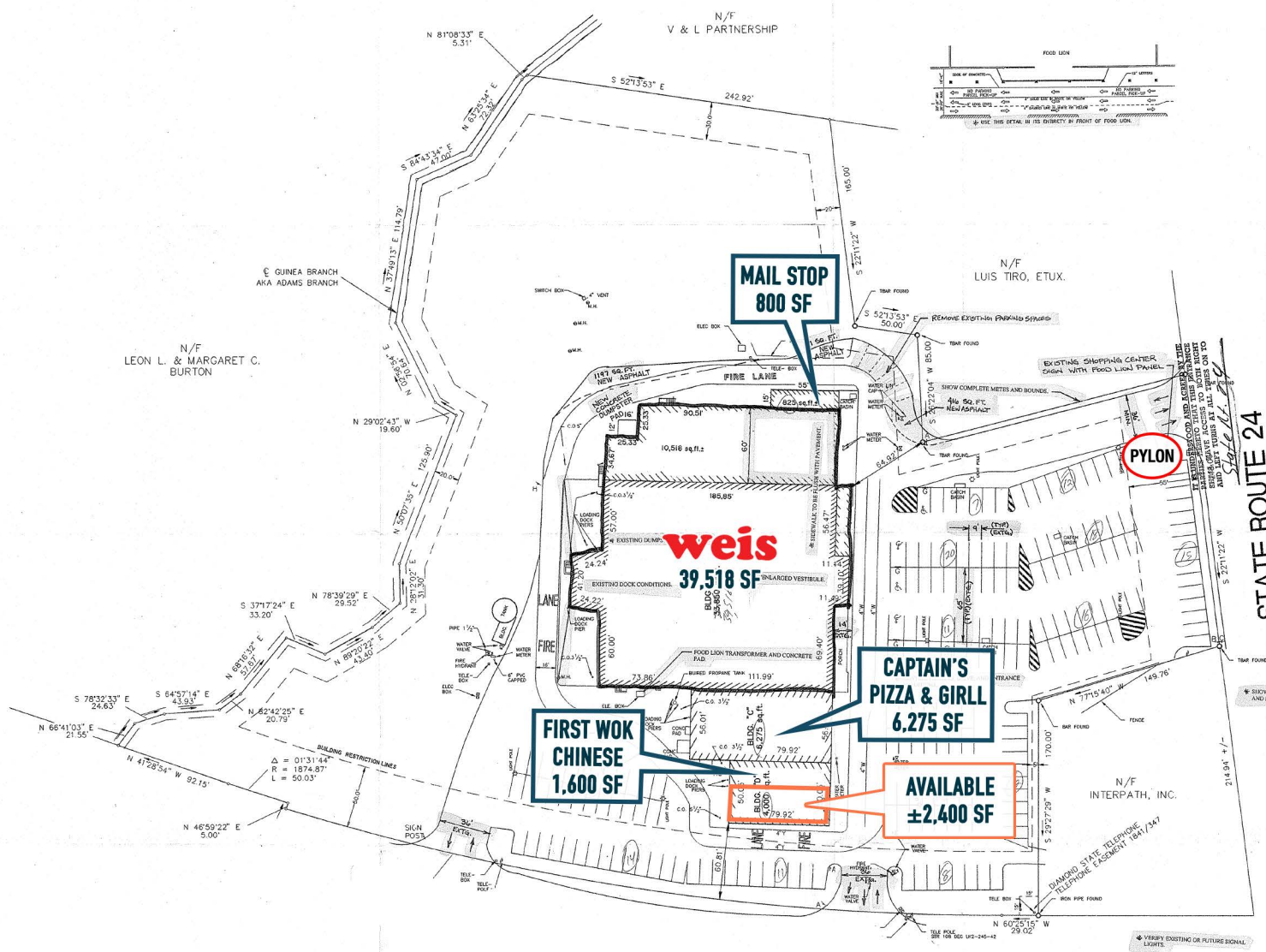

N/F
LEON L. & MARGARET C.
BURTON

N/F
V & L PARTNERSHIP

N/F
LUIS TIRO, ET. UX.

PYLON

STATE ROUTE 24

N/F
INTERPATH, INC.

The information and images contained herein are from sources deemed reliable. However, Metro Commercial Real Estate, Inc. makes no representation whatsoever as to their accuracy or authenticity. Images shown may be modified for illustrative purposes. Images may be out-of-date and not current. 02.03.25

NANTICOKE CROSSING
MILLSBORO, DE
24832 JOHN J. WILLIAMS HIGHWAY



MetroCommercial.com